



16.20.2.32 N215095

Project Name : Nelson Square Dog Park Consultation Report

Submission Summary

16 September 2021 – 7 October 2021

Report generated on 8 October 2021

Project Overview

Council invited the community to give feedback on our first ever dog park concept plan from Thursday 16 September 2021 to Thursday 7 October 2021.

Goal 3 of Council's Open Space Strategy is to increase the range of functions available in our open spaces. One of the actions against this goal is to create a dog park. The inclusion of this action was driven by community feedback and a petition to Council requesting the provision of a designated dog park in Port Lincoln.

The project has been allocated a budget of approximately \$200K, plus some additional footpath and car parking works, and this is being funded out of federal funding which needs to be expended by 31 December 2021.

Dog parks provide a safe and secure environment for dogs and humans to get together, exercise and play whilst in a controlled environment with minimal impact on the surrounding area and neighbourhood.

The new dog park is located centrally in the existing open space of Nelson Square and maximises the retention of the native vegetation to the north and south of the site. Existing native vegetation is retained within the northern aspect of the dog park, providing shade, visual amenity and a sense of connection to place. Additional pockets of new planting and shade trees are included within the park. These plantings provide exploratory opportunities that will enrich the dogs' experience at the park.

The existing landscape surrounding the dog park is to be retained with some of the native vegetation thinned and under story pruned to improve sight lines into the Reserve while still providing a natural barrier between the park and neighbouring properties.

The design of the dog park considers the needs of both humans and dogs and embraces the various interactions that can occur between dogs and people. The design provides a secure fenced space where dogs can sniff, play and exercise off leash in a naturalistic environment that is in keeping with the existing amenity of the reserve.

The key features of the dog park include:

- **Perimeter fencing** — perimeter fence (chainmesh) to complement the surrounding natural vegetation and to minimise dogs going over, under or through the fence.
- **Entry/exit points** — multiple access points have been designed to minimise congestion in these high traffic areas.

Report generated on 8 October 2021

- **Double gates** — double gating system with safety airlock, self-closing gates, and accessible latch.
- **Circulation paths** - series of internal paths to encourage dog owners to walk with their dogs through the space. The internal paths are DDA compliant allowing dog owners or visitors that are mobility impaired to use the dog park.
- **Activity spaces or zones** — variety of exploratory zones to give dogs a range of opportunities within the dog park.
- **Surface materials** — variety of texture and experiences for dogs including sand, organic mulch, and concrete for paths.
- **Drinking fountain** - drinking fountain for both human and dogs
- **Amenities** - shelter, formal and informal seating.
- **Waste disposal** - bins and dog bag dispensers.
- **Signage** — educational signage on dog behavior and dog park rules/ etiquette.

An on-site information session was held at Nelson Square Reserve, on Tuesday 28 September 2021, from 5.00pm – 6.00pm, where the community could provide feedback and discuss the concept plans with Council staff.

Click this link to view the Nelson Square Dog Park Concept Plan in full or refer to the Key Documents section on the right of screen.

Please note: The area on the concept plan outside of the dog park design is set aside for determination of future use, this does not mean that Council has decided that this land is surplus and will be available for disposal - however subject to future consideration of the uses of the reserve, that may be a future consideration, however any discussion around disposal of reserve land will involve community consultation.

Hardcopies of the Nelson Square Dog Park Concept Plan were made available at the Council Administration Office and Port Lincoln Library from Thursday 16 September 2021 to 5pm on Thursday October 7, 2021.

Nelson Square Dog Park Concept Plan Submission Summary

Number of Submissions : 40

Respondent	Subject	Description	Attachments
1	Nelson Sq Development	I think the development of Nelson Square into a dog park is an excellent initiative. I live local to the area i.e. walking distance and would visit each every day. There are currently no fenced dog exercise areas in Port Lincoln and I think it is a big issue. It leads to people exercising their dogs in areas that are not designated or safe for group dog exercise. My biggest concern is fully fenced for dog and child safety. Children need to be able to be present but not necessarily inside the dog area with the dogs. Please consider adjacent play areas for families who are taking the dog for a walk and taking children with them for a family outing or by necessity. This is quite common in my experience in Port Lincoln. Please consider separate areas for large and small dog exercise. I have visited parks like this in Adelaide and they work very well. Please also consider other fence areas i.e. playgrounds that might be available for dog exercise prior to 9am and after 5pm. E.g. Wellington Square. My experience in Adelaide is that attending dog parks lead to positive social interactions between community members and would be a great way for people who are socially isolated to meet other people in the community and make friends. I commend the Council for prioritising the establishment of a dog park.	-
2	Nelson square dog park	Afternoon, Hoping for this to go ahead. I think that park desperately needs an upgrade.	-

Report generated on 8 October 2021

Respondent	Subject	Description	Attachments
3	dog park feedback	I think it is great you are considering an off-leash dog park. I am not a fan of where it is going but I will be happy to have one available in any case. However, I do think you need to put more stimulation in for the dogs like there are in other parks in the cities. My suggestion is in the image attached. A tunnel, a ramp or something that we can use to continue to train our dogs and keep them mentally stimulated would be great. I would like you to consider adding this in.	Refer Attachment 1
4	Nelson Square Dog Park	I fully support the need for a dog park at Nelson square I have a concern as my mother and father in law who live at number █ Volante Street directly opposite. This no doubt will become the only dog park in an enclosed area for the whole of Port Lincoln for a number of years. I have concerns that the land which is council owned between the roadway and the front allotment of number █ Volante Street will be utilised by members of the public and park their vehicles there. My father-in-law currently maintains the upkeep of that land by mowing it on a regular basis and having vehicles park there will kill off the grass. I feel there would need to be some type no parking on the grass or Verge in front of their property. Council needs to advertise that there are multiple entry points and that it is recommended that they don't just choose the main entrance as the congestion they're potentially on the weekends could become an issue and as I have reiterate especially about parking on the grass outside their house it's human nature people will park there. Please take my consideration on behalf of my mother and father in law.	-
5	Nelson Square	Nelson Square is a park and should be kept as such. It is owned by the community, It is not a piece of land to be profited from. It has been lacking love for such a long time and now needs	-

Respondent	Subject	Description	Attachments
		to be upgraded. A dog park is a great idea but also to keep the scrub land, kids still love to play there and I have always used it for walking my dogs over many many years. The park should not be divided up with unused land to maybe sold off later. Please upgrade the whole park.	
6	Nelson Square Dog Park	YES finally a designated dog park, congratulations Port Lincoln City Council. Can't wait to see it up and running and I am sure my dogs will be happy to see it come to pass as well. Would rather see projects like this than what I believe is the reinventing of the foreshore area - please leave our beautiful foreshore as it is we don't have to follow the other city councils, let the Port Lincoln foreshore remain unique as it is. Thank you.	-
7	Nelson Square Dog Park	I think a purpose built and maintained dog park is exactly what is needed in this town. As a dog owner myself with quite a few dog owning friends there is a lack of 24/7 leash free areas in town. The Nelson Square park is a prime location as well. If you could retain as much of the native flora as possible that would be ideal.	-
8	Road Safety Training Park (Public Land)	From examination of the great plans for a Dog Park, Nelson Square has unallocated space within the site. We respectfully urge Council to adopt the concept of a Road Safety Training Park, which could be managed on the unallocated area. The attached files were drafted for the Windsor Ave land but could be adjusted to suit the site.	Refer Attachment 2

Respondent	Subject	Description	Attachments
9	Dog park and Nelson square feedback	Really like the design, have 2 dogs myself and would use this park. Would love to see another undercover area included in the design for shade and weather protection when visiting park. I have attended many dog parks in Adelaide and like the design of this, however have found at other parks I have attended the undercover areas can become very crowded in unpleasant weather, and as such a second area would cater to more people! Also a second water bowl area for the dogs would also be beneficial due to this reason- often become very crowded at peak times of use and can lead to doggy disagreements at times. Love the layout and the intention to clear vegetation of non-native species. Please consider upgrading the rest of the square in time into a larger park with new play equipment, preferably under shelter as has been done in Kimba. They have an incredible playground with a jumping pillow and really fabulous playground. Port Lincoln is a major tourist hub and this would be of such a benefit to not only the local community but to the larger EP community and tourists visiting the area!!	-
10	Dog Park	This is a fantastic I will certainly use this park I do now	-
11	Dog Park	Hello, I strongly agree with the idea of establishing a specific dog park which is fully fenced is a great idea given that the current area is Mundys Mooring which is not fenced in and therefore requires closer supervision. Please ensure this is kept as well, though. Having a specific park for dogs acknowledges the share of dog owners in the community and their need to exercise with their animal in a safe setting. It might be a good idea to have a small separate section for smaller dogs in addition to a large general area, as is the case in other dog parks I have visited in the past. Once again, please go ahead with this project while funding is available. Thank you.	-

Respondent	Subject	Description	Attachments
12	Dog Park	City of Port Lincoln very much needs a fenced dog park, all for this.	-
13	Dog Park	Great idea and its way past due.	-
14	Submission - Nelson Square Dog Park Concept Plan	I strongly support this project proceeding. Thank you.	-
15	Dog Park concept plan	Hi, I am not sure how to do the survey. I have a small dog & I think it would be great to have a dog park. I am on oxygen & can't walk too far so I was wondering if there would be a chair quiet close to gate to sit on. Are there going to be disabled parking. So let's hope it all goes through. Thank you.	-
16	Dog park	This is a great idea, as a Dog trainer it's good to have a space for dogs to be off leash. However it can be overwhelming for dogs or a recipe for fights, please consider a separate section for puppies, and some climbing equipment like a board a tunnel etc for dogs to play on xx	-
17	Submission - Nelson Square Dog Park Concept Plan	Nelson Square dog park 1. Question: what happened to the proposal to have the dog park at the larger, more suitable Pioneer Park?	-

Respondent	Subject	Description	Attachments
		<p>2. No native vegetation at Nelson Square should be disrupted in anyway except for the removal of weeds until orchid surveys are complete. No herbicides should be used to control any weeds until orchid surveys are complete (see below).</p> <p>3. There are at least 7 species of orchids that could occur in the native scrub. Orchids are protected. The species that could occur there flower from February through to December. Surveys need to be carried out from February until December to determine their presence before any clearing can occur. I found (this month) a possible <i>Microtis</i> sp. at Nelson Square. The following species may be present – flowering period in brackets:</p> <p><i>Cornistylus nigricans</i> (February) <i>Acanthus pusillus</i> (April-May) <i>Calonema capillatum</i> (July-August) <i>Calodenia latifolia</i> (July-September) <i>Thelymitra nuda</i> (September-November) <i>Microtis arenaria</i> (October-December) <i>Diplodium dolichochilum</i> (May-September)</p> <p>4. If you mark the proposed paths with flagging tape and stipulate the width of the proposed tracks, you can contract me to survey for orchids to determine presence/absence of the above species across the months above. If any orchids are found, I shall suggest a suitable variation to the proposed track(s).</p> <p>5. If the tracks in the southern vegetation are not to be any wider or more extensive than exist at the moment, this vegetation patch possibly doesn't need to be surveyed for orchids. If new tracks are proposed through existing vegetation they need to be surveyed for orchids. If no changes to the vegetation are proposed at all to the southern vegetation outlined in the</p>	

Report generated on 8 October 2021

Respondent	Subject	Description	Attachments
		<p>proposal, perhaps the dog areas (if they are to go ahead) could be implemented in stages to allow for the orchid surveys to be completed in the northern area.</p> <p>6. The original sign must be retained. It has historic value. If it must be removed, please make it to available to me.</p> <p>7. The playground equipment is used every afternoon after school. Do not remove the playground equipment. If it must be removed, shift it to another area of the Square.</p> <p>8. Do not remove the tennis courts in the south-western corner (outside current scope). These are used regularly and are important spaces for citizens from a wide range of socio-economic levels. A net has been provided for use. Maintain the net if necessary.</p> <p>9. PLCC should do a reply-paid letter drop to all households that border Nelson Square to ensure that there are no objections that can't be addressed to ensure that the quality of living in that location will not be compromised by the establishment of the dog park. Not all individuals have computers or purchase the Lincoln Times and so should not be discriminated against. The questions put to the householders need to be both valid and reliable.</p>	
18	Submission - Nelson Square Dog Park Concept Plan	<p>Dear Council, I write to provide feedback and suggestions regarding the proposed dog park in Nelson Square. I am very much in favour of a dog park for Port Lincoln as a way to enhance community connections between people, and therefore mental health and social capital. Dogs will also benefit from the opportunity to socialise and exercise. I used to live in Adelaide and have attended a number of dog parks with my dog. I have seen that the dog parks there are in constant use, with many people attending at regular times and therefore building friendships for people and familiarity between dogs. The dog park in the North Adelaide (in Park 5, adjacent Robe Terrace) is one that works particularly well because it has separate areas for</p>	-

Respondent	Subject	Description	Attachments
		<p>large and small dogs, which increases dog safety and confidence. I think the area proposed for the dog park in Nelson Square is too small. Please find a way to provide separate areas for large and small dogs to play separately. The Adelaide parks are generally irrigated and grassed, and considerable wear and tear occurs on the grassed areas. In Nelson Square, it appears that natural grass cover will not be irrigated or replaced, and so I anticipate that it will become very dry and dusty quite quickly. This will potentially be unpleasant for park users. A larger area may ameliorate this without the need for irrigation. I think that parking should be provided off street in the centre of the Square, as is currently possible (near to the old toilet facility). This would reduce the neighbourhood impact and increase safety for people and dogs getting in and out of vehicles. I agree with the proposed removal of the non-indigenous trees and the other proposed plantings. I hope that the remainder of the park is not sold off for development. The old courts are in need of either removal or refurbishment. My suggestion would be to consider creating another children's playground with family picnic area and a couple of refurbished courts, perhaps one for basketball and one for tennis. A community garden would also be great if a community group could be formed to establish and maintain one. If the playground / picnic area is to be established, a public toilet will be necessary for all patrons of the park. This area of Kirton Point in general is more run-down than adjacent areas and so a spruced-up Nelson Square would be a great new community asset. Congratulations to the Council for proposing the dog park. Please try to expand the vision into a park well fit for purpose for years to come.</p>	
19	No dog park at Nelson square	No dog Park at Nelson Square. I do not want to see Nelson square become a dog park. In addition, I do not want the tennis court area subdivided and sold off. This is a space where families should be able to come together and spend time. In order to do this, council should	-

Respondent	Subject	Description	Attachments
		be spending their money on upgrading the current courts and playground area, making it an area for children of all ages to use - not dog and their owners. The trees should also be maintained and protected and the grassed areas mowed regularly. This is a residential area, not an area where children are not able to play safely, because council (without adequate consideration or consultation) has decided to put in a dog park. No dog park for any part of Nelson Square!	
20	No Dog park at Nelson Square	I would like to voice my objection to the dog park at Nelson square. I find it incredible that Council has spent so much money paying for the production of glossy plans, when they have not even consulted with the ratepayers, especially those who are directly impacted. No dog park or sale of any part of Nelson Square.	-
21	Open Space Strategy	Overall strategy for Nelson Square appears to be comprehensive and well thought through. I support the plan.	-
22	Nelson Square Dog Park Concept Plan	I would like the concept plan to take into account the whole of the Nelson Square Reserve and not just the top portion for the dog park. Obviously, the works on the bottom portion could be undertaken in the future when funds are available however I would like to see a plan included now for its future use rather than the area being set aside for determination at a later date. I live on Cardiff Road opposite the tennis courts on the Reserve and my children and I regularly use the courts. It would be great if a couple of tennis courts could be retained and upgraded and a basketball ring added, along with play equipment suitable for young kids.	-

Respondent	Subject	Description	Attachments
		This would complement the Dog Park and make the Reserve suitable for a wide range of people and families.	
23	Nelson Square Dog Park Concept Plan	<p>This email is to express my disapproval of the dog park concept at Nelson Square Playground.</p> <p>I lived at ■ Dublin Street directly below Nelson Square as a child for 12 years, and for the last 13 years have lived at ■ Eltham Avenue three houses away from the park. I am well aware of how the playground and tennis courts have deteriorated over the years and I feel that the council has purposely neglected the space with the long term view to remove the park and develop housing. Despite the lack of funding, people USE that park and LIKE the way it is. I used that park as a child (and still do), and now my children use it along with many others – even the tennis courts get used regularly in the state they are in not only for tennis but for many activities including kids learning to ride bikes!</p> <p>My family and I are opposed to a dog park and are annoyed that we have not been consulted before now after a great deal of money has been spent on a concept plan and the 31 December deadline looms.</p> <p>My major concerns are</p> <ol style="list-style-type: none"> 1. The removal of trees, shrubs & habitat. We want the natural look and feel of the scrub to remain and ideally have more large trees planted. I am concerned that the scrub will be cleared and we will lose bird and animal life for a sterile ‘city style’ park surrounded by fences 2. We need to retain space for kids to go and play, practice sport or just be outside! It is hard enough to pry kids away from screens. We need to give them something they are keen to go to that is easily accessible. My family uses the park regularly, and at present, my kids are riding their bikes around the bike track. They spend hours over there! 	

Respondent	Subject	Description	Attachments
		<p>3. I own two dogs, but feel no need for a dog park. We are blessed in Kirton Point to have wide streets, trails and access to beaches and open spaces. There is no need for a dog park here, especially one of this scale. I understand people across town may not have the same benefits close by, and may desire a dog park, but if so make it more accessible to that side of town and keep it out of Kirton Point! I would not use a dog park anywhere in Port Lincoln, but in my opinion it should be away from housing and Ravendale would be the most suitable location. This proposed park is too close to too many houses.</p> <p>My suggestions are</p> <ol style="list-style-type: none"> 1. Don't touch the trees (or as few as possible) 2. Improve the existing playground area and build a shelter and BBQ area so that families can use this space. There is currently no seating or decent shade in the playground area. A toilet facility would also be useful! 3. Come up with a plan (in consultation) to improve the tennis court area. Retain a couple of tennis courts but a basketball court would be hugely popular – kids and adults are always using the basketball court at Kirton Point Primary School 4. If a dog park must go ahead in this space, down size and relocate it to the central part of the block (the tennis court 'car park') that is already mostly cleared but has some nice big trees already established. There is ample space <p>Please reconsider this plan. We do not want it to happen! It is going to spoil the area for those who live here, and won't get used by those who don't after the initial novelty wears off!</p>	

Respondent	Subject	Description	Attachments
24	Nelson Square	<p>After many years living in Kirton Point I was pleased to see the park near me, Nelson Square, finally earmarked for an upgrade. Over close to 40 years living near the park and using it with my children, dogs and grandchildren, we have only seen play equipment removed and clubhouse and courts neglected. To my horror, the plan is a dog park with no intention for keeping anything for the children and families of the area. One of the beauties of our park is the scrub, with lizards, orchids, birds and other attractive native shrubs and should be left natural. In my opinion the park should be left unfenced (unnecessary cost). The playground needs upgrading, perhaps with some plantings among equipment for space and interest. I think at least 2 tennis courts should be retained and up kept. They are used regularly and should never be taken from the park. Perhaps also on the already level area a small basketball court. I would like to see the cricket net upgraded with a lawn area out from it, between courts and playground for running and ball play. A covered barbecue with shade trees around would be an added asset as well. A toilet similar to Shelley Beach or train park should also be included. Some dead or unsightly trees could be tidied up. I feel with this plan the park can continue being us for children and families, as it was originally intended, for many years to come. I'm completely against Nelson Square becoming a dog park and find it insulting to the community around us.</p>	-
25	Nelson Square	<p>My previous submission was made under the impression that the Council was going ahead with its proposal for Nelson Square.</p> <p>Thank heavens it's not a <i>fait accompli</i>.</p>	

Respondent	Subject	Description	Attachments
		<p>As voiced by the 50 or so people present, I reiterate the following:</p> <ol style="list-style-type: none"> 1. No dog park in Nelson Square 2. No subdivisions (as mooted by PLCC) of Nelson Square for housing. 3. Preserve the square in accordance with the original intention of the area when it was surveyed. 4. Up-grade the children's playground. 5. Retain the sign. 6. Retain and maintain at least 2 tennis courts. 7. Carry out weed control but in a manner that does not destroy any native vegetation. 8. Given that Pioneer Park is already off-leash, fence an area there, if it is absolutely necessary to have a fenced area, as a 'dog park'. 9. Matthew Morgan's presentation was excellent but carry out an exercise such as this before thousands of dollars are wasted drawing up plans by someone in Adelaide who has no idea of the wishes of regional country people and that will never be used in Nelson Square. Listen to the residents!! 10. Submit the points recorded on the butcher's paper to Council. These were not quantified but Council should see them and they are 'in writing'. If it needs a signature to qualify as a submission, I would be happy to sign it and could get other residents if you require it. 11. Do not demolish the toilet block. Get an assessment from a reputable builder to modify it unless it is beyond repair (which it doesn't seem to be). 12. Provide seating in various places. 13. Barbecue areas could add to the general usage of the area, particularly when the playground is up-graded. <p>Thank you to Matthew and other staff for holding the event. Thank you to the young woman who handed out 'have your say' cards to everyone. That was an excellent idea. Thank you to the one</p>	

Report generated on 8 October 2021

Respondent	Subject	Description	Attachments
		Councillor (Robyn Rowsell) who bothered to attend – it was good to see at least one elected member present.	
26	Your Say - Nelson Square Dog Park	I am excited about the prospect of having somewhere safe to take my dog. I have noticed that many of our “unleashed” dog areas are not fenced. I understand there are some concerns from neighbouring properties about the development of this land. So I can’t speak to that. But as a parent who frequents the local parks, some of which double as unleashed areas, I am also excited to have a space dedicated to dogs so that the parks can remain somewhat free of unrestrained dogs. We often have interactions with dogs who are friendly but who are not obedient. This isn’t always positive for young children. If we were living in the city, this would be embraced. I feel as though country areas need to consider the way that we invest in our community with the entire community in mind - not just those who live in the immediate area. In short, as a mother with young children and a dog, I think this is a fabulous idea and I am excited to utilise it, respect it and promote it.	-
27	Nelson Square Dog Park	<p>Having attended the on site consultation session my take away conclusion is as the white board comments unanimously show.</p> <p>The site for the dog park has met with strong public disapproval, even dog owners agree, because it has taken over the Children’s Playground, [needing up dated equipment]</p> <p>A more acceptable site would be on the four unrepairable tennis courts area taking in the decommissioned toilet amenities building. [or demolish pending]</p>	

Respondent	Subject	Description	Attachments
		<p>Refurbishing the two good concrete courts where children and parents can have a casual hit.</p> <p>Volante St. Sealed Car Park and continued Footpath is a definite yes, as is the removal of non-indigenous pine trees and general clean ups.</p>	
28	Nelson Square	<p>Hi, I have tried 3 times to submit and I keep losing my written content and starting to get very annoyed. So I'll keep it brief. I oppose the dog park being constructed in Nelson Square. It's really nice and quiet here and once the proposed park is built it no longer will. The playground needs to be improved and stay as children are more important than dogs! Find another location and council don't even think of trying to sell off surplus land for residential purposes as I oppose that also! It's a reserve and it needs improving and kept that way! Council spend some finances on it for a change as in the 21 years I've lived on Cardiff Rd I never noticed much being spent on it. The wildlife need protecting and need the reserve as their forever home.</p>	-
29	Nelson Square	<p>I don't believe the nelson square dog park conversion is not a good idea as a young person who plays sports it's an easy access point to practice and work on skills. I take my dogs over there for a run while I use the tennis courts to hit a ball, and watch the other young children around using the area to ride bikes, or use the playground or come use the courts after I have. Losing the park is a major error for the community and younger demographic as it'll promote the decrease of younger people not going outside.</p>	-
30	No dog park at Nelson Square	<p>I do not agree with the proposed dog park in Nelson Square for the following reasons:</p>	-

Respondent	Subject	Description	Attachments
		<ul style="list-style-type: none"> - It is not a big enough area for all size dogs - Why do dogs have preference over children and adults? - Sandpits are an unhealthy area for children to play in (unless covered when not in use) so why introduce it where dogs and cats can defecate and children naturally use it to play in, and disease can be spread. - I propose that the Dog park is not considered and that the money allocated for the park is utilised in the upgrading and tidying of ALL of Nelson Square. The Square has been badly neglected for so long. Garden (non-native) plants should be removed. Locals to this area pay our rates so why has Nelson Square been neglected? A building with toilets incorporated was built many years ago for use by the tennis clubs. This could be used by the general public. I think the natural nature of the park enriches the lives of children and adults alike. <p>Wellington Square is a lovely park but Nelson Square is completely different and unique and it would be a travesty to destroy that. I definitely feel that the residents in this area have been overlooked and that it is time to listen to them and their concerns for their children and their own well being. That was very evident by all present at the meeting held in Nelson Square on 28/9/21. I definitely do not agree with the selling of 'spare land'.</p>	
31	Nelson Square Dog Park	<p>My name is [REDACTED] and I am 15 years old. I am fortunate to live near Nelson Square, and I want to live next to a reserve, not a dog park. My cousins live nearby too, and we all use the park a lot. I think money should be spent on upgrading the park for people, not dogs. I feel sorry for the young families who use the park because there is hardly any play equipment for them to use. If there was more equipment, more people would use it. I spend a lot of time over in the park with my cousins, we ride our scooters on the tennis courts, ride bikes on the dirt tracks</p>	-

Respondent	Subject	Description	Attachments
		<p>through the scrub. We kick the footy, and play soccer on the grass area, and use the playground sign as our goal. We also practice baseball, and throw the ball to each other and practice our batting. My sister practices her softball throwing and hitting on the grass too. I would love to see a basketball ring built there. Someone built one on the tennis courts which we used, but it kept getting vandalised and was pulled down. I currently have to go to Kirton Point School to use theirs, and sometimes they remove the backboard so people can't use it. You have to pay to use the Leisure Centre. This would be a great addition for kids my age, and get us off screens and out in the fresh air more (this would make parents happy also). I would like Council to add more play equipment, not remove what is there. More people would use it then. Wellington Square is too far, and you can't ride bikes or scooters there. I love my local park and want to see it kept as a playground and reserve for future generations of kids like me to enjoy.</p>	
32	Nelson Square Dog Park	<p>I am a home owner, resident and ratepayer of Port Lincoln who will be unhappily affected by any proposed dog park being built at Nelson Square, and I am appalled at the prospect of having one located across the road from me. Ask yourself whether you would want to live across the road from a dog park? It's as bad as living across from a school. Would you enjoy the sound of dogs barking day and night? I would never knowingly buy property anywhere near a dog park (who would???!), and am now potentially having one IMPOSED on me. Instead of birdsong, I will hear dogs barking. No more nice and quiet area to enjoy, which is why I chose to live here. How will this affect property prices? I have already had people asking me if I am going to try to sell my house before the dog park gets built. A dog park does not belong in a quiet, residential area such as Nelson Square (and I personally would never risk taking my dogs to use it). Many of the residents who live around Nelson Square</p>	-

Respondent	Subject	Description	Attachments
		<p>are elderly and have lived there for 40+ years, and should be entitled to the peace and quiet they have enjoyed all those years, not be subjected to barking dogs. The residents around Nelson Square are very attached to the reserve. There are also many young families in the area who could (and would) utilise the playground if it was upgraded and play equipment added, not taken away. A lot of people use the park despite the limited play equipment – imagine the use the park and playground would get if it had not been reduced over many years to the current neglected state that it has been allowed to deteriorate into. People already use the park to walk their dogs, there is not a need for a dog park there. Dog owners have existing off leash areas they can use.</p> <p>If rates must be spent on building a dog park, would it not be better situated in a non-residential area, such as at Ravendale by the old (unused) tennis courts, where it would be in an industrial area and dog barking would not impact on residents? There are already two dog kennels in the area (so barking dogs are an existing occurrence), and they could use the dog park to exercise dogs as well. Locating the dog park in a non-residential area would mean that residents would not be affected by the noise of barking dogs or people using the park in the early morning or late evening. As the park is planned to be open 24/7, in summer (during daylight saving) residents could potentially be subjected to dogs barking from early morning until sundown, which could be after 9pm. Dog owners are not always considerate and no amount of 'dog park etiquette' will stop the impact of their noise on local residents. The residents should be able to enjoy a summer evening, not be subjected to noise and dogs barking.</p> <p>Lastly, NO future subdivision and sale of land of Nelson Square – this Reserve matters to the locals, and should remain a playground and park for future generations to enjoy, not be divided up and sold off. Spend rates and funding on upgrading open spaces for people, not</p>	

Report generated on 8 October 2021

Respondent	Subject	Description	Attachments
		for dogs. Plan for, and maintain, the reserve as a whole, not just a component of it. I hope the plan for a dog park at Nelson Square is not a foregone conclusion, and that Council will duly consider the feedback received, in particular from locals of the area who will be the most affected.	
33	Nelson Square Dog Park Feedback	No portion of Nelson Square should be sold, and it should be conceived and improved as a whole, rather than adding the dog park then reconsidering the remainder of the park.	Refer Attachment 3
34	Nelson Square Dog park.	To whom it may concern, my name is [REDACTED] and am a long time resident of Kirton Point, as is my immediate family and extended family live not too far away from Nelson Square. I feel not too much consideration has been made for the local kids in the proposed development and would like to see some planning towards this and more consultation with locals. Thankyou.	-
35	No dog park at Nelson Square	I have lived next door to Nelson Square for 50 years, and seen the change from a viable playground (admit some equipment was dangerous but I survived!) and thriving tennis club to being ignored by council for many years. As a child the highlight was definitely the natural bushland and trails. I am insulted the council are now looking at developing the area for dogs when nothing has been done to improve the area for children and families. Despite the neglect, Nelson Square is still used regularly by local residents. In particular families playing informal tennis and riding bikes and skateboards on the old tennis courts, and many for walking amongst the trees, often with their dogs. I am very disappointed money has been	Refer Attachment 4

Respondent	Subject	Description	Attachments
		spent on a city based company to provide concept plans for the dog park prior to local residents being consulted. Instead of taking away areas already used for families, wouldn't it be better to use an area such as open space on Kent Place for a dog area? Nelson Square is unique with its natural bushland and I would like to see this preserved. All parks do not need to have manicured gardens and lawns (which require costly watering). With additional play equipment and a shaded BBQ area Nelson Square would be further utilised.	
36	Nelson Square Dog Park Concept Square	Please find my objection to proposed Nelson Square dog park concept plan.	Refer Attachment 5 I218900
37	Nelson Square Dog Park Concept Plan	At the new dog park please increase the off-street parking and consult on disability infrastructure to lead others by shining example	-
38	Nelson Square Dog Park Concept Plan	Open Space Park for all to use. 6 to 10. A dog park would have to be 5 to 10ha of open space for large dogs to benefit outside built up area to avoid noise from barking. New families coming to our area from infill we need the family access to be preserved. It's our park.	Refer Attachment 6 I218897
39	Nelson Square Dog Park Concept Plan	Hardcopy Submission	Refer Attachment 7

Report generated on 8 October 2021

Respondent	Subject	Description	Attachments
			I218898
40	Nelson Square Dog Park Concept Plan	City of Port Lincoln 'Day at the Park' Information Session – 28 September 2021, 5pm to 6pm Community Responses via the Comments Board	Refer Attachment 8 I218864

ATTACHMENT 1

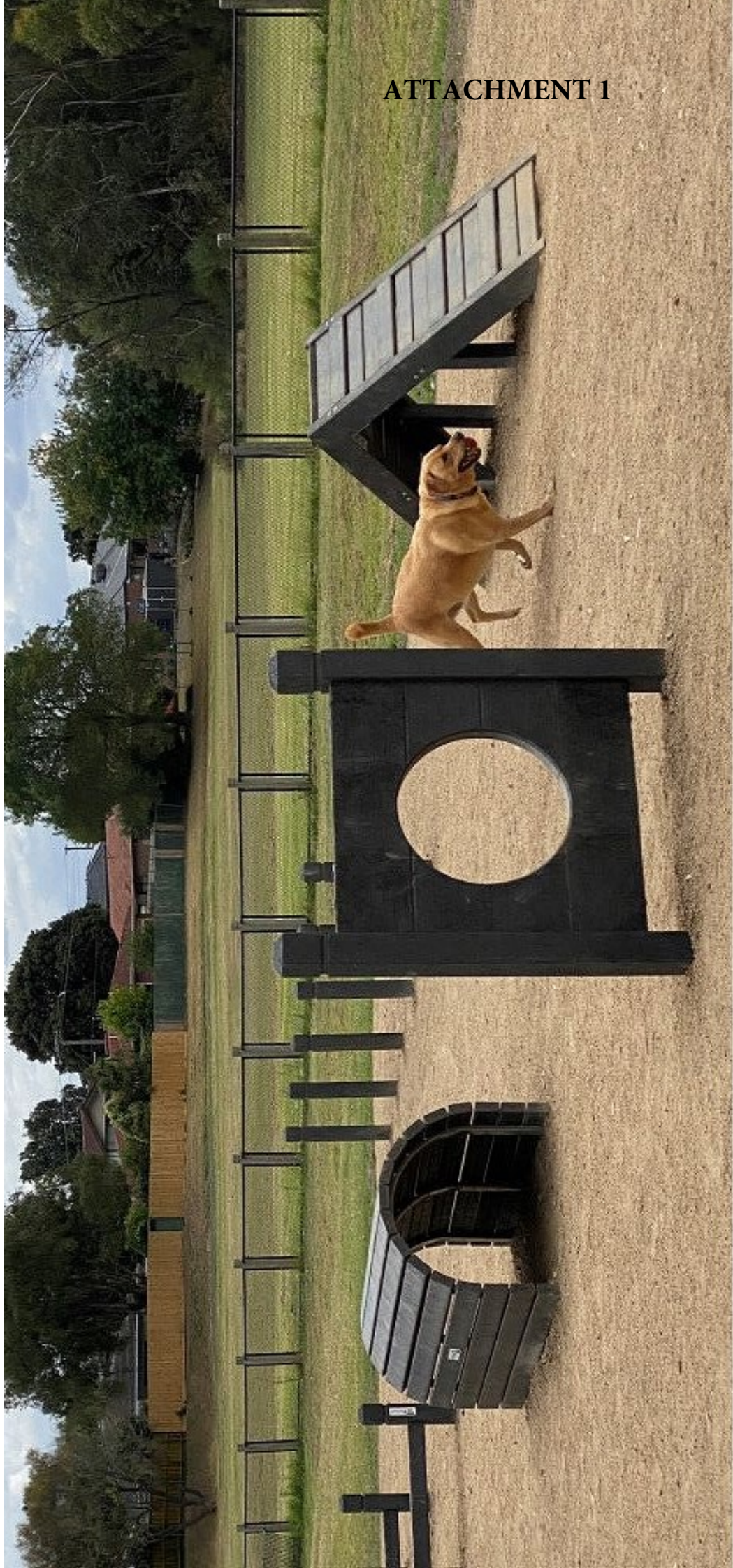

ATTACHMENT 2

[REDACTED]

Community Project for consideration and adoption

Proposal:

The establishment of a formal Road Safety Training Park on Council Land at the corner of Windsor Ave and Proper Bay Road.

This facility is intended to provide a road safety training park equipped with everyday road fixtures and features that will inform and train children from all areas of the southern Eyre Peninsula.

Background

The [REDACTED] has been in existence for a considerable number of years, being active in the promotion of road safety campaigns, deploying mobile speed indicator signs, working in collaboration with SAPOL, Department of Transport, Councils and Schools. Of recent times the Committee has discussed the practical training of the youths of our zone regarding road safety. We were inspired by the activities of the road safety group at Port Pirie and this was confirmed by reports we received of a similar facility at Whyalla. The idea is not copyright to our Group. After deliberation, our Group resolved that we would adopt the idea of a road safety park for southern Eyre Peninsula as a project. Early discussions with a previous Chief Executive of Port Lincoln City Council revealed that there are certain allotments of council land which could be suitable for such a project. After consideration we decided that the land at the corner of Windsor Ave and Proper Bay Road would be the most suitable, due to its location, size, zoning and existing infrastructure.

Our Group then used plans sent to us from Port Pirie to guide staff from Lowe Redding Design to prepare a concept park on the chosen land site. After an extended period of consultation amongst our group we have settled on the design and features displayed on the plans that are laid before you at this time.

Discussion

First of all our Group wishes to assure Council that there is no expectation that Council will just say, "good idea" grab it and run away and develop it. We see this idea as a community project that will be superintended by Council as the land owners and funded from as many organisations as we can gather to subscribe to the establishment and operation of the park. Recently the RAA was advertising that it was open for applications for grants for road safety ideas. Community Banks have always been generous with financial support for many community projects.

[REDACTED]

These sources come to mind without much effort which makes me believe that with the right people orchestrating the project and knowing which doors to open to get work done, it will be a feature of our southern Eyre Peninsula.

Added to this is the thought that if we get this park up and operating, and just one young life is saved due to its activities, then the effort to get there will be worth it.

Recommendation

That Council note the submission from the [REDACTED] regarding the establishment of a road safety training park and hereby adopts the plans provided by the [REDACTED] for use as the basis for including the concept in future community projects with aspects relating to funding, supervision, operations and maintenance to be established at a later date. Furthermore that Council consider the establishment of a select committee under the Local Government Act to oversee and control this adopted scheme to ensure clarity and transparency at all times.

[REDACTED]

[REDACTED]

[REDACTED]

ATTACHMENT 3

NELSON SQUARE DOG PARK FEEDBACK

Nelson Square, included in the initial 'Plan of the Town of Port Lincoln' has been an appreciated and cherished open space in Kirton Point for many years. Unfortunately, Port Lincoln City Council hasn't shown it the respect and care that it and Kirton Point ratepayers deserves, and the park has been neglected.



Whilst the park is regularly used by people including children riding bikes, skateboards and scooters and playing in the playground and scrub, walkers, tennis players and people exercising their dogs, reactivating the park through careful design is welcomed.

No portion of Nelson Square should be sold, and it should be conceived and improved as a whole, rather than adding the dog park then reconsidering the remainder of the park.

The dog park design itself is appropriate for its purpose. However, in the larger plan of the whole of Nelson Square, is it in the most suitable position when considering the children's playground, tennis courts and utilisation of the complete open space?

I note that most of the dog parks in the Adelaide area are sited in locations with low residential populations. Many are near industrial and commercial properties or inside larger parks and reserves. Perhaps a dog park would be better located in the centre of the larger Pioneer or Puckridge Parks, as a part of the Murrays Point improvements, or at Ravendale Sports Complex. Although Brinkworth Reserve is within the DCLEP, this is another site that is away from condensed residential housing and is already used as a dog exercise area. The Happy Valley Cemetery reserve, bordered by Eric Ave and Breton Place, has a large area of unutilised land that could be utilised as a dog park, with access via Bernard Place. The site has existing public toilets and is not close to residences.

The Kirton Point area is becoming more population dense as large blocks are subdivided. More families have moved and are moving into the neighbourhood and Nelson Square is becoming even more utilised and valued.

My vision for the park is to have a nature-play playground, to retain 1 or 2 of the existing tennis courts, to remove the Aleppo Pines, plant more native trees, retain the existing scrub and trails and add a barbeque area and public toilets. A dog park could be a part of this concept.



Nature-play playground equipment - a shoutout to our Ospreys.....

Dog Park Community Consultation Comments/Feedback 28 September 2021

Session at Nelson Square – 5:00-6:00pm

- More consultation with residents
- **Already have off-leash area for dogs (Pioneer) why wreck Nelson Square?**
- **Bikes not dogs – keep our BMX Jumps**
- Preserve all native scrub
- **Basketball court/ring**
- More Activity for teenagers
- Play ground for a range of ages
- Bigger and better playground
- Dog Part at bottom half – middle by Car Park?
- **No Sale of land for houses! ✓**
- **Space for kids not dogs ✓**
- Keep the two concrete tennis courts
- More playground equipment
- **No barking dogs**
- Dog park at Ravendale – less residents
- Seats for parents & BBQ
- **No sale of land for houses**
- **Space for kids not dogs**
- Keep park as a complete rec area. No division of the square
- No removal of any trees
- **Property prices affected talk to people who live here**
- **No dog park, thanks ✓✓✓**

Comments in **Bold** were circled

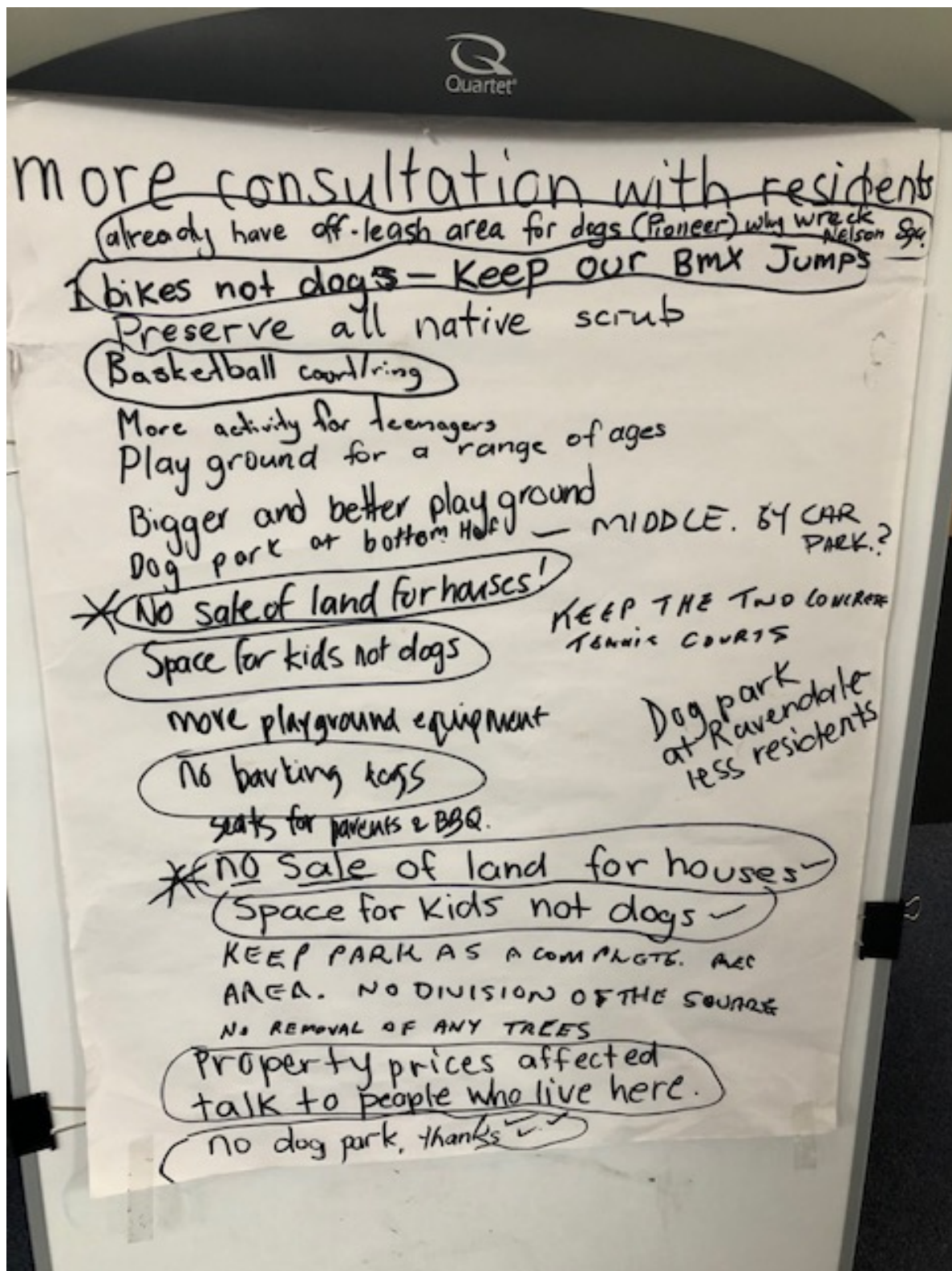

Comments on concept dog park for Nelson Square

Vegetation remnants

Opening up the remnants by “thinning” for sight distances (CPTED) or “formalising” informal paths will degrade the remnants and create noise pathways from the dog park into adjoining residential development. The remnants are of such a small size not to justify CPTED given noise impact considerations. The non-indigenous pine trees were likely planted as part of Nelson Square and therefore have local cultural heritage values and provide screening as well as likely to be used by fauna such as birds. Proposed actions should:

- 1 Reduce the size of the dog park so as to exclude remnant vegetation from the dog park to leave the part of the remnants in will only degrade them;
- 2 remove weeds only with replacement by native vegetation as well as retain mid-storey vegetation for screening;
- 3 non indigenous pine trees to be retained for screening and faunal uses;
- 4 allow informal paths in the remnant vegetation to “grow over” and be integrated back into the remnants;
- 5 plantings with known food source or ecological values for native fauna including birds, reptiles, insects and bees. The southern remnant appears to service native bees and European bees – native bees require native food sources;
- 6 unleashed dogs at a minimum to be excluded from vegetation remnants to protect native fauna and to stop the remnants being used as dog toilets and garbage dumps. Ideally, dogs should be excluded from the remnants;

Dog park fencing

Perimeter fencing should be a barrier to noise transmission and stop incursions by native fauna such as lizards (“sleepy lizards”), skinks etc into the dog park. Dogs will harry or savage reptiles if given an opportunity. Proposed actions should:

- 1 erect fencing of a type that both integrates an accredited acoustic treatment into it and will also stop reptile incursions entering the dog park;

Playground and Tennis Courts including various

The poor standard of the existing structures in the park is notable and a sad indictment on council’s maintenance standards which would have led to less patronage by users.

The removal of the old playground as part of the dog park is not supported. The old playground should be replaced with one that complies with the relevant state or federal standard. Dogs should not have precedence over children.

Design Statement

The design of the dog park puts the needs of users and their dogs above the needs of residents who live in the adjoining residential precinct. It should not be a surprise that not all people like dogs and it’s clear that dogs are noisy especially in a group.

People and their dogs will visit the dog park, the dogs will be uncontrolled (unleashed) which will result in noise impacts on adjoining dwellings. This also includes additional noise and impacts from traffic movements.

Was a noise study considered in the design process for the concept plan for a dog park at Nelson Square and Council's draft open space strategy? If so, is that study available to the public? Background noise levels and noise impacts from turning the park into a dog park should have been considered in a study prior to identifying Nelson Square as a proposed dog park or indeed proposing any other dog park near a residential area. Council has a duty of care to consider impacts from proposed development including recreational uses on adjoining residential areas.

The general use of Nelson Square including the use of proposed new paths in the remnant vegetation will be discouraged by nearby residents and other visitors to the square if the dog park goes ahead due to impacts from dog barking.

Management

No information has been provided in the plan on the management of the dog park including its hours of operation, maintenance schedule and operational funding.

Land Devaluation/Impacts on Residential Amenity

Approval of a dog park within an established residential area will devalue residential land as noise from dogs will impact on residential amenity.

[REDACTED]

[REDACTED]

Port Lincoln 5606 S.A

7/10/2021



OPEN SPACE
PARK FOR ALL
TO USE

A DOG PARK WOULD HAVE TO BE 5 TO 10 HA
OF OPEN SPACE FOR LARGE DOGS TO BENEFIT
OUTSIDE BUILT UP AREA TO AVOID NOISE FROM BARKING
NEW FAMILIES COMING TO OUR AREA FROM INFLUENCE

LOW MAINTENANCE
PARK

WE NEED THE FAMILY ACCESS TO
BE PRESERVED. ITS OUR PARK.

~~DOG PARK~~ & Exercise Area Nelson Square

Landscape Concept

September 2021

GRANTS ARE FOR.
REAL PROJECTS
NOT STRANDED
ASSETS. ~~THE STRANDED ASSETS~~

~~THE STRANDED ASSETS ARE NOT REAL PROJECTS~~

THERE IS 250 000 K IN RATES PAYED IN THIS AREA
NONE SPENT HERE.
WE DONT WANT TO WALK OUR DOGS ON ROADS

WE NEED FOOT PATHS.

DOG PARK & EXERCISE AREA

Nelson Square Landscape Concept

Project No. 21PLD Date of Issue 13.09.2021



Site Context



1

KEEP ARCH.



2

OK



3

NO NEW PUBLIC ACCESS
CAR ACCESS SUFFICIENT

1. Entrance sign
2. Off street carpark to Volante Street.
3. Recently built bridge to Cardiff Road.
4. Existing play equipment and sand areas
5. Tennis courts (Outside scope)
6. Cricket pitch.
7. Vehicular and pedestrian access towards commissioned public toilets.
8. Vehicular access loop.
9. Native remnant vegetation.

KEEP ACCESS

DOG EXERCISE
AREA



4

UPGRADE PARK PLAY EQUIPMENT
LEAVE SAND AREAS



5

DOG EXERCISE PARK



6

REMOVE + REPLACE WITH
BARBECUE AREA + SHELTERS

REMOVE OLD CRICKET
PITCH

REPLACE WITH BARBECUE
AREA + SHELTERS
FACING NE.

1 BUILDING DIVIDED
INTO 3 3X3 METRES EACH.
STILL
USE THIS AREA
FOR PARKING

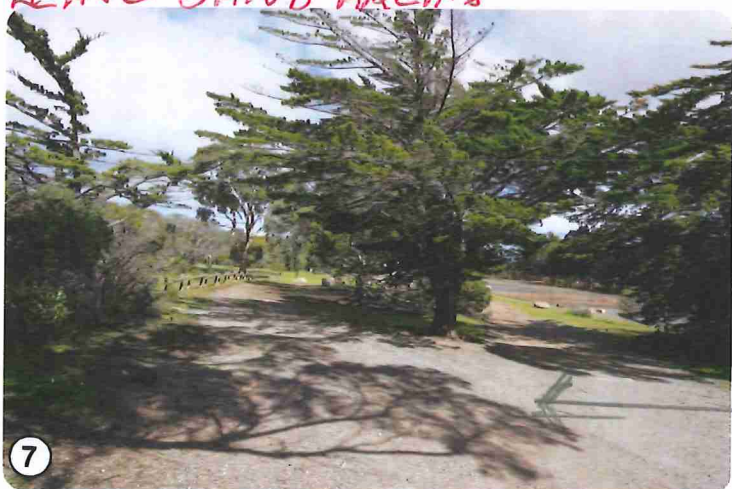

7

KEEP ACCESS
TO CARDIFF ROAD FOR PARKING AREA



8

BEST PLACE FOR CAR PARK
CENTRAL TO ALL ACTIVITIES



9

NO NEW TRACKS
IN NATIVE VEG AREAS

DO NOT DISTURB
NATIVE VEG AREAS

DOG. TRAINING AND PARK & EXERCISE AREA

Nelson Square Landscape Concept

Project No. 21PLD Date of Issue 13.09.2021

Overall Site Plan

GRANTS ARE MEANT
TO BE SPENT WISELY

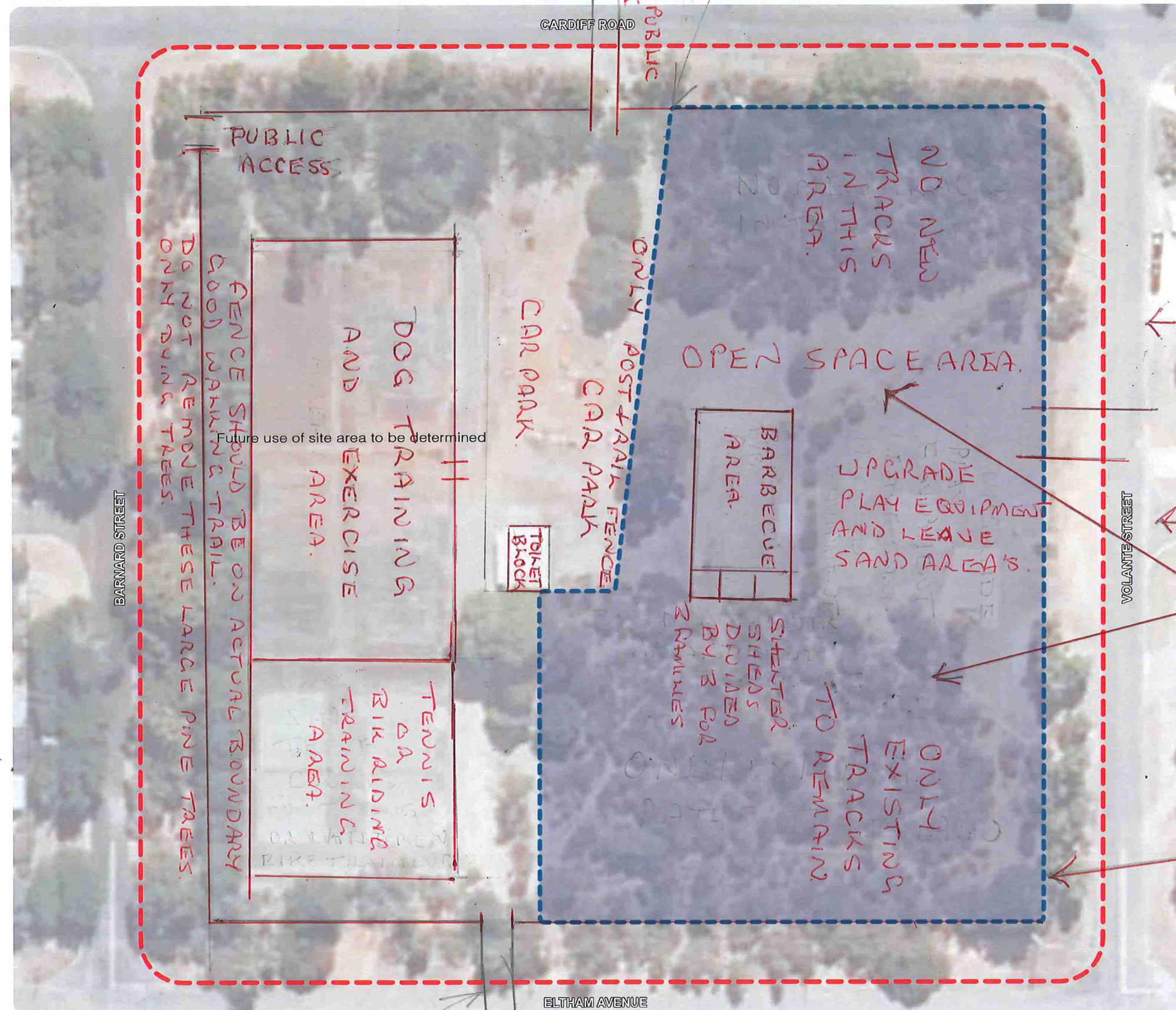

--- Site
--- Scope of works

COMMUNITY
OPEN SPACE
PARK

CAR PARK

ACCESS
THROUGH
ARCH.

CAR PARK

REMOVE OLD CONCRETE BARRIER
AND NONE NATIVE TREES
TWO GUMS AT END OF USE POLL LIVES

IF AREA HAS TO BE FENCED MUST BE
ON SURVEYED BOUNDARY
& ONLY 1.7 METRE HIGH.

1:750@A3
0 15m

WE NEED FOOT PATHS.

DOG ~~PARK~~ & EXERCISE AREA

Nelson Square Landscape Concept

Project No. 21PLD Date of Issue 13.09.2021

Existing Site Analysis



- Native remnant vegetation
- Non indigenous pine trees to be removed
- Stobey poles
- Existing formal pedestrian access
- Informal pedestrian tracks
- Vehicular access

1. Main access to existing play area through arched sign
2. Quarry fines parking bay to Volante Street
3. Play equipment to be removed (Sand for recycling)
4. Main open lawn and kick about area
5. Concrete kerb to be removed
6. Open terraced lawn area
7. Concrete cricket pitches to be removed
8. Post and rail timber fence
9. Decommissioned toilet to be demolished (Outside scope)
10. Rubble carpark (Outside scope)
11. Secondary pedestrian and vehicular access to Cardiff Road
12. Newly built verge to Cardiff Road
13. New pram ramp
14. Secondary pedestrian and vehicular access to Eltham Street
15. Tennis courts to be removed (Outside scope)



DOG PARK & EXERCISE AREA

Nelson Square Landscape Concept

Project No. 21PLD Date of Issue 13.09.2021

Spatial Plan

OPEN SPACE.
AREA MUST BE KEPT IN PERPETUITY
FOR FAMILIES TO ENJOY FOR ALLTIMES

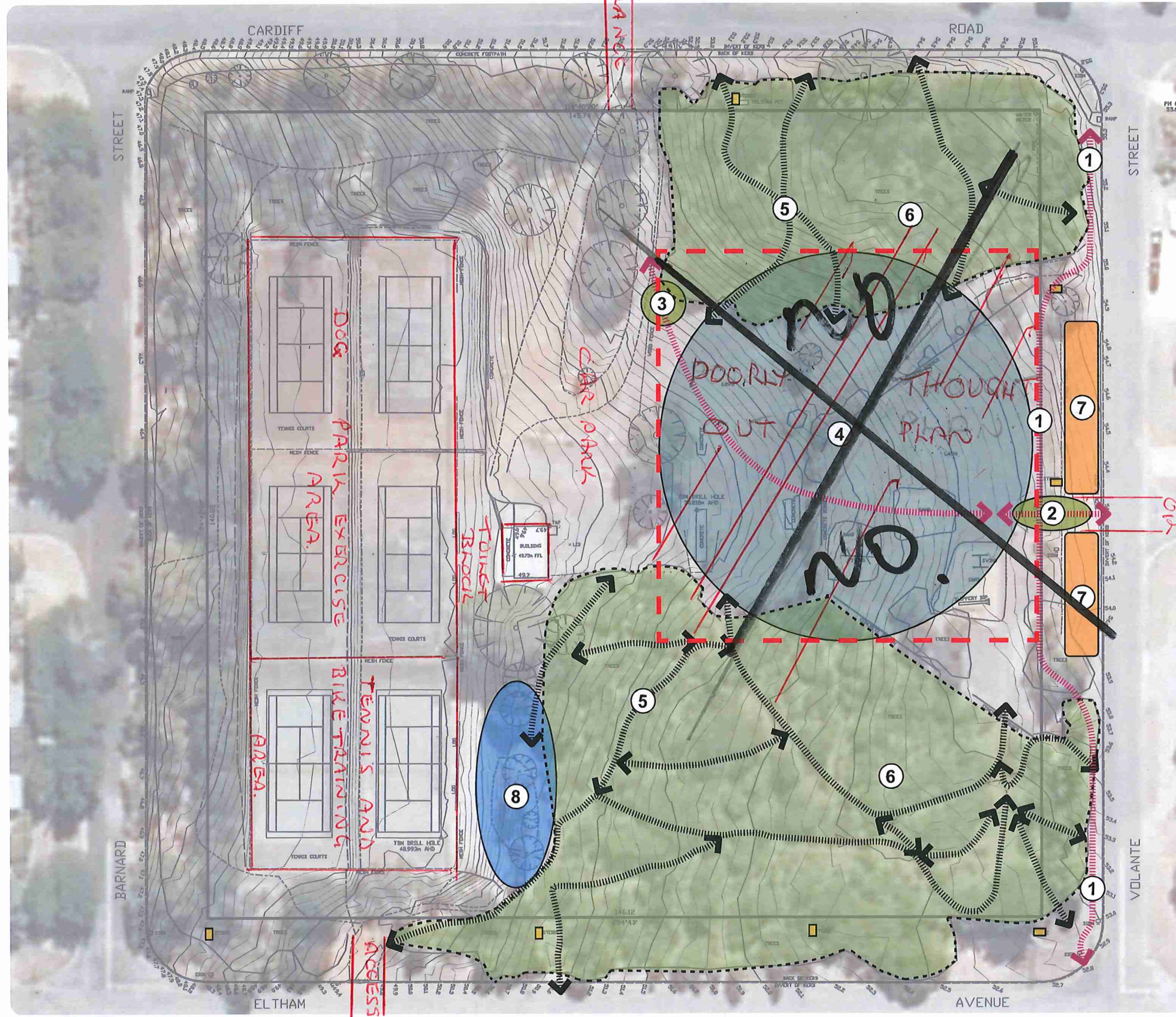

- Main pedestrian movement
- Informal pedestrian movement
- New dog fence (Approx. Area 6,200m²)
- Existing remnant vegetation
- Entry statement landscape
- Dog park and exercise area
- Carpark

1. New verge with pram ramps to Volante Street
2. Main pedestrian access with entry landscape and refurbished sign
3. Secondary pedestrian access point with entry landscape and signage
4. Dog exercise area
5. Informal tracks retained and enhanced with reduction of understory planting to improve sight-lines and CPTED
6. Native vegetation cleared of invasive species
7. Existing parking bay refurbished with inclusion of DDA compliant park
8. External sensory nook and waiting/gathering area

VERY POOR DESIGN & CONCEPT.
(NO NEW TRACKS)

COUNCIL HAS POOR RECORD
WHEN SPENDING RATE PAYERS
MONEY.

BETTER PLAY EQUIPMENT

BETTER FOOT PATHS IN THE AREA.

WE ALL HAVE TO USE ROADS NOW
TO WALK OUR DOGS

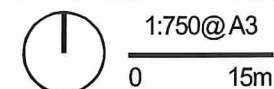

PEOPLE NEED TO WALK 4-6KM PER DAY
SAFELY. AREA IS NOW HAVING
6-10 NEW HOUSES BUILT WITH INDEED
YOUNG FAMILIES OCCUPYING THEM

~~DOG PARK~~ & EXERCISE AREA

Nelson Square Landscape Concept

Project No. 21PLD Date of Issue 13.09.2021

KISS.
KEEP IT SIMPLE. STUFF



Concept Plan - Overall

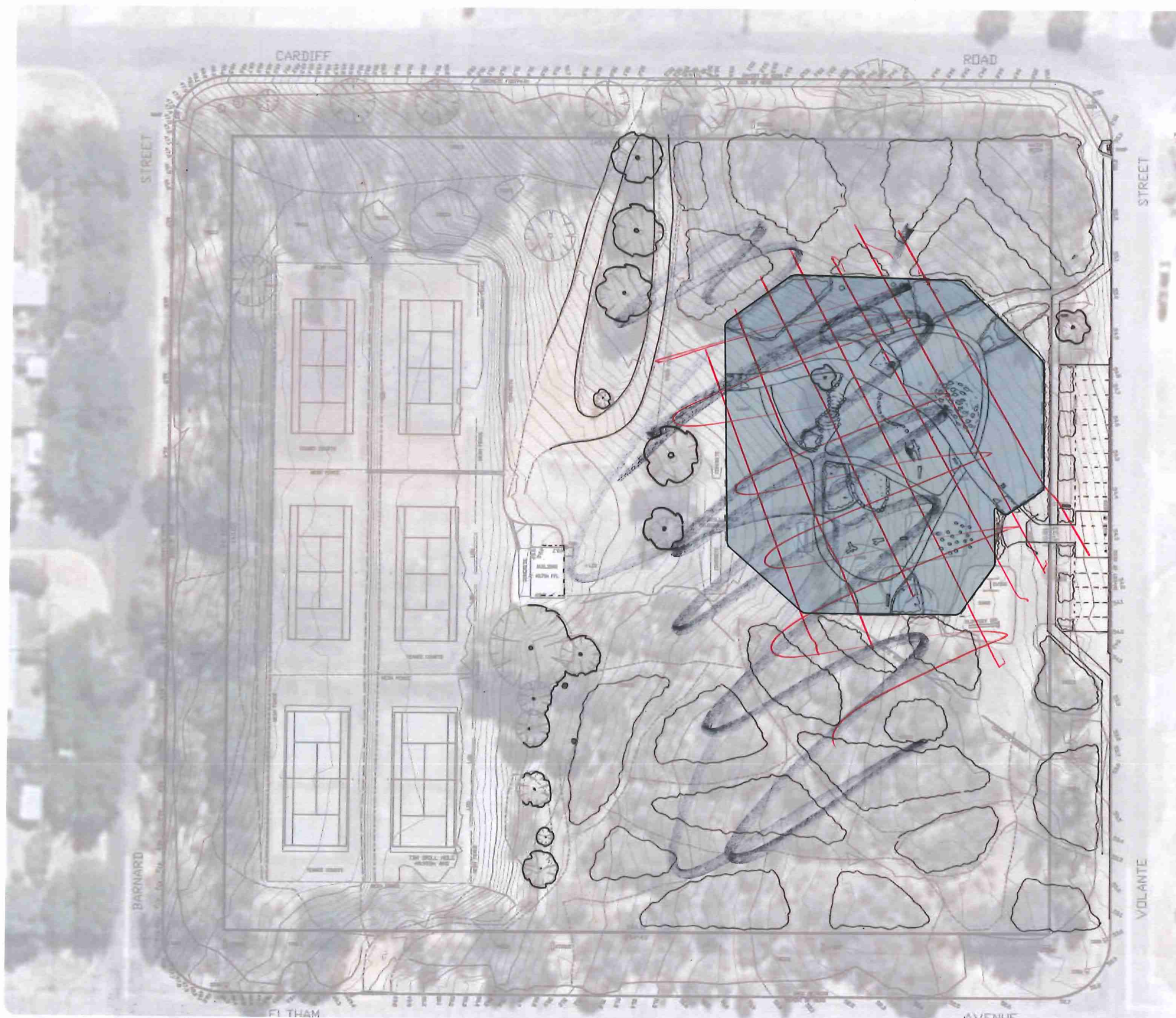

Dog Park Area (approx 3000m²)

Design Statement

The new dog park is located centrally in the existing open space of Nelson Square and maximizes the retention of the native vegetation to the north and south of the site. It provides an asset for the whole community, revitalising the reserve, retains connections to existing trails and provides opportunities for a range of users.

A sense of arrival to the park is created through restoration of the existing park entrance sign and a new pedestrian connection to Volante Street. Access to the park is improved with an upgrade of the existing informal car parking to Volante Street, and the inclusion of two new DDA compliant access paths.

The design of the dog park considers the needs of both humans and dogs and embraces the various interactions that can occur between dogs and people. A secure fenced space where dogs can sniff, play and exercise off leash in a naturalistic environment that is in keeping with the existing amenity of the Reserve.

A central main pathway leads visitors through the site between the two double-gated entrances (doggie airlocks) and to a central shelter and seating node. Informal secondary paths are provided to encourage dog owners and their dogs to keep moving in the space, helping to reduce dog-dog conflict.

The park provides numerous nature based canine play and sensory opportunities including an in ground sand pit, balance logs, a low rock clad mound and a vertical timber log 'forest'. These play nodes are distributed throughout the park, between non-programmed areas to allow for informal and unstructured play and socialisation opportunities.

Existing native vegetation is included within the northern aspect of the dog park, providing shade, visual amenity and a sense of connection to place. Additional pockets of new planting and shade trees are included within the park and are protected with raised timber and log edging. These plantings provide exploratory opportunities that will enrich the dogs experience at the park.

Additional park amenity is provided including a drinking fountain and a tilting dog bowl, rubbish bins with dog bag dispensers, bench seating and informal congregation areas and signage outlining good etiquette and behaviour in the dog park and surrounds.

The existing landscape surrounding the dog park is retained with some of the native vegetation thinned and under story pruned to improve sight lines into the Reserve.

1:750@A3
0 15m

YOU COLLECT
250K IN RATES.
GIVE US SOME BAC



LEAVE
MOST OF
PARK AS
IS. WE LIKE
IT THAT
WAY
NOT
INTERESTED
WASTE OF MONEY
KEEP PARK SIMPLE
AND COST EFFECTIVE
SPEND MONEY
ON FOOT PATHS
IN OUR AREA

TOO
EXTENSIVE
NEED NATURAL
OPEN SPACE

LOW COST PARK

1. Sealed car park with wheel stops, utilising existing crossover.
2. Verge path connection (outside scope)
3. DDA compliant parks and central access path 2.5m wide
4. Buffer planting to car park
5. Existing entrance sign refurbished
6. 2.5x2.5m airlock gate entrance with accessible locks & self closing gates
7. 1.6m high black cyclone fence with top & bottom rails
8. Central 2.0m wide brushed concrete path
9. 1.2m wide compacted quarry rubble path
10. Earth mound (800mm high) with rock steppers & retaining
11. Entrance sign on arrival garden
12. Timber seating pod
13. Drinking fountain on brushed concrete with tilt round dog bowl & overflow to adjacent garden bed
14. 4x4m Landmark skillion roof shelter
15. Existing remnant vegetation & trees. Mid storey planting thinned to maintain sight lines
16. Informal log edging to garden beds to protect vegetation
17. Rock seating node in compacted earth path
18. Raised rock & log edge to sand pit with flush entrance adjacent path
19. Vertical timber log 'Forest'
20. Natural logs
21. Concrete pipe tunnel with rock retaining to edge of mound and compacted quarry fines path to top of mound
22. Split log balance in softfall mulch
23. Full height signage to fence line
24. Park bench seating with back support
25. New indigenous plants & trees with protective log edge
26. Existing dry land grass area
27. Existing remnant vegetation pruned & thinned around informal pathways with some mid storey vegetation & existing weed pines removed
28. Maintenance gates
29. Bins with dog bag dispenser
30. Way finding lighting to existing stobey poles at entrance and car park

1:250@A3
0 10m

DOG PARK & EXERCISE AREA

Nelson Square Landscape Concept

Project No. 21PLD Date of Issue 13.09.2021

Moodboard Images Dog Play

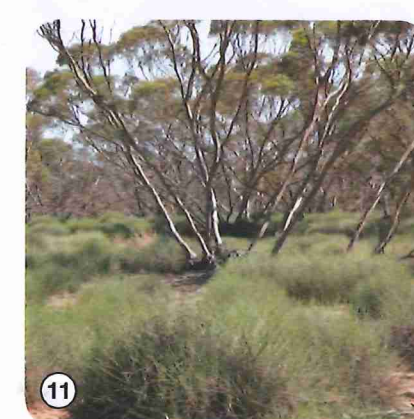
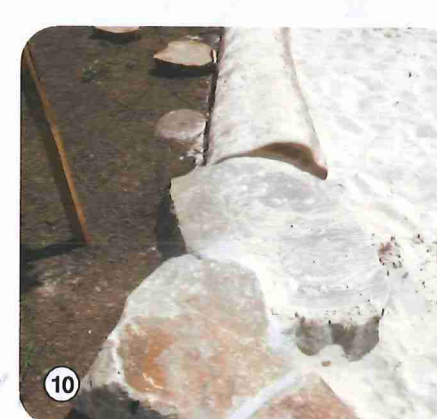
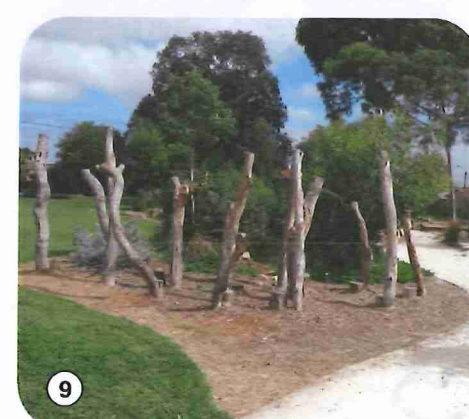
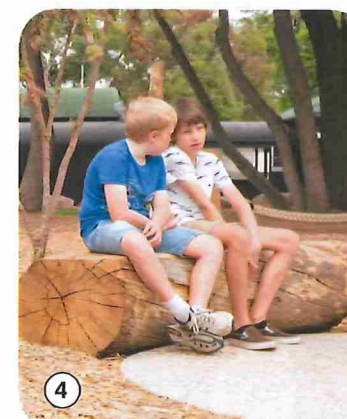
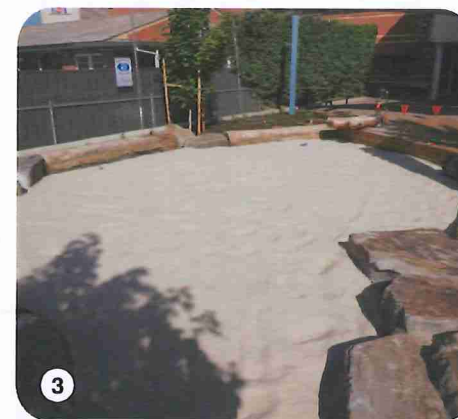
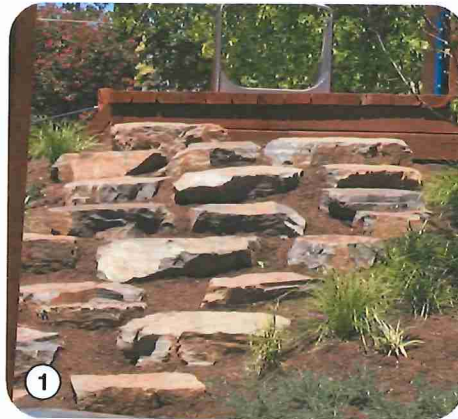

1. Earth mound with rock steppers
2. Informal logs & softfall mulch
3. Sand pit
4. Log seating
5. Rock seating node
6. Split log balance
7. Compacted quarry fines path
8. Carved log balance
9. Vertical timber log forest
10. Rock & log edge to sand pit
11. Remnant vegetation mid storey pruned for sight lines
12. Informal log edge to path

DOG PARK & EXERCISE AREA
Nelson Square Landscape Concept
Project No. 21PLD Date of Issue 13.09.2021



Moodboard Images Amenity

O P E N S P A C E .



1. Drinking fountain with tilt round dog bowl
2. Dog bag dispenser
3. Park bin
4. Signage to fence line
5. Signage to fence line
6. Airlock gate entrance with accessible locks & self closing gates
7. 1.6m high cyclone fence with strip kerb to base
8. Compacted quarry fines path
9. Central brushed concrete path
10. Timber pod seats
11. Park bench with back rest
12. Timber skillion roof shelter



LOW COST PARK ONLY

DOG PARK & EXERCISE AREA

Nelson Square Landscape Concept

Project No. 21PLD Date of Issue 13.09.2021

Overall Site Plan



- Site
- Scope of works

SQUARE COMPLETELY FENCED.
AS SHOWN BY RED ---
1.5 METRE HIGH.
ELECTRIC BBS } IF
AND SHELTERS } WELLINGTON
PLAY GROUND SAME AS
WELLINGTON SQUARE
SAVE ABSOLUTE MAXIMUM OF
NATIVE FAUNA + FLORA



DOG PARK & EXERCISE AREA

Nelson Square Landscape Concept

Project No. 21PLD Date of Issue 13.09.2021

Existing Site Analysis



- Native remnant vegetation
- Non indigenous pine trees to be removed
- Stobey poles
- Existing formal pedestrian access
- Informal pedestrian tracks
- Vehicular access

1. Main access to existing play area through arched sign
2. Quarry fines parking bay to Volante Street
3. Play equipment to be removed (Sand for recycling)
4. Main open lawn and kick about area
5. Concrete kerb to be removed
6. Open terraced lawn area
7. Concrete cricket pitches to be removed
8. Post and rail timber fence
9. Decommissioned toilet to be demolished (Outside scope)
10. Rubble carpark (Outside scope)
11. Secondary pedestrian and vehicular access to Cardiff Road
12. Newly built verge to Cardiff Road
13. New pram ramp
14. Secondary pedestrian and vehicular access to Eltham Street
15. Tennis courts to be removed (Outside scope)



Dog Park Community Consultation Comments/Feedback 28 September 2021

Session at Nelson Square – 5:00-6:00pm

- More consultation with residents
- **Already have off-leash area for dogs (Pioneer) why wreck Nelson Square?**
- **Bikes not dogs – keep our BMX Jumps**
- Preserve all native scrub
- **Basketball court/ring**
- More Activity for teenagers
- Play ground for a range of ages
- Bigger and better playground
- Dog Part at bottom half – middle by Car Park?
- **No Sale of land for houses! ✓**
- **Space for kids not dogs ✓**
- Keep the two concrete tennis courts
- More playground equipment
- **No barking dogs**
- Dog park at Ravendale – less residents
- Seats for parents & BBQ
- **No sale of land for houses**
- **Space for kids not dogs**
- Keep park as a complete rec area. No division of the square
- No removal of any trees
- **Property prices affected talk to people who live here**
- **No dog park, thanks ✓✓✓**

Comments in **Bold** were circled

more consultation with residents

(already have off-leash area for dogs (Pioneer) why wreck Nelson Sp?

Bikes not dogs - Keep our BMX Jumps

Preserve all native scrub

Basketball court/ring

More activity for teenagers

Play ground for a range of ages

Bigger and better play ground

Dog park at bottom Half - MIDDLE. BY CAR PARK?

*NO sale of land for houses!

Space for kids not dogs

KEEP THE TWO CONCRETE
TENNIS COURTS

more playground equipment

No barking dogs

seats for parents & BBQ.

Dog park
at Ravenhall
less residents

*NO Sale of land for houses -

Space for kids not dogs -

KEEP PARK AS A COMPLETE. AEC

AREA. NO DIVISION OF THE SOURCE

NO REMOVAL OF ANY TREES

Property prices affected
talk to people who live here.

no dog park, thanks ✓✓